

RESOLUTION 10175

A RESOLUTION BY THE CITY COMMISSION OF THE CITY OF GREAT FALLS, MONTANA, TO EXTEND THE BOUNDARIES OF SAID CITY TO INCLUDE LOTS 8-11, BLOCK 5, LOTS 1-5, BLOCK 6, AND LOT 7, BLOCK 15, THANIEL ADDITION MAJOR SUBDIVISION PHASE 1 OF THE TYNDALL MINOR COUNTY SUBDIVISION TRACT #2, LOCATED IN THE SW ¼ SECTION 26, TOWNSHIP 21 NORTH, RANGE 3 EAST, CASCADE COUNTY, MONTANA, IN ACCORDANCE WITH THE PROVISION OF SECTION 7-2-4601, MONTANA CODE ANNOTATED; ALL AS SHOWN ON THE MAP ATTACHED HERETO MARKED ATTACHMENT "A" AND BY THIS REFERENCE MADE A PART HEREOF.

* * * * *

WHEREAS, the City of Great Falls is a city incorporated under the laws of the State of Montana, and having a population of more than ten thousand (10,000) is a city of the first class; and,

WHEREAS, there is contiguous to said City, but without the boundaries thereof, certain tracts or parcels of land situated in the County of Cascade, State of Montana, and described as follows:

LOTS 8-11, BLOCK 5, LOTS 1-5, BLOCK 6, AND LOT 7, BLOCK 15, THANIEL ADDITION MAJOR SUBDIVISION PHASE 1 of the Tyndall Minor County Subdivision Tract #2, located in the SW ¼ Section 26, Township 21 North, Range 3 East, Cascade County, Montana, and consisting of ± 2.5 acres,

all as shown on the map attached hereto marked Attachment "A" and by this reference made a part hereof and according to the final plat of Thaniel Addition Major Subdivision Phase 1; and,

WHEREAS, Section 7-2-4601, Montana Code Annotated, provides that whenever the owners of real property contiguous to any incorporated city of the first class petition to have said property made a part of the municipal corporation, such lands may be embraced within the corporate limits thereof and the boundaries of such city of the first class extended so as to include the same; and,

WHEREAS, the owner of the hereinabove described property has submitted a petition to have said property annexed to the City of Great Falls; and

WHEREAS, the City Commission finds that it is to the best interest of the City of Great Falls and its inhabitants to proceed with the incorporation of said territory into the City of Great Falls; and,

WHEREAS, all of the proceedings herein have been conducted in strict compliance with and in conformity to the laws of the Montana Code Annotated, Title 7, Chapter 2, Part 46. Annexation by Petition, and all conditions, acts, and things required to be done precedent to and in the passage and adoption of this resolution have been properly and legally done, and performed.

NOW, THEREFORE, BE IT RESOLVED BY THE COMMISSION OF THE CITY OF GREAT FALLS, MONTANA:

That the boundaries of the City of Great Falls, Montana, be and the same are hereby extended so as to embrace and include within the corporate limits of said city all of the land hereinabove described, included as: LOTS 8-11, BLOCK 5, LOTS 1-5, BLOCK 6, AND LOT 7, BLOCK 15, THANIEL ADDITION MAJOR SUBDIVISION PHASE 1 of the Tyndall Minor County Subdivision Tract #2, located in the SW ¼ Section 26, Township 21 North, Range 3 East, Cascade County, Montana.

BE IT FURTHER RESOLVED BY THE COMMISSION OF THE CITY OF GREAT FALLS, MONTANA:

That the Cascade County Clerk and Recorder is hereby authorized and directed to change the appropriate district boundaries of the City of Great Falls, Montana, to include said tract of land; and,

That this Resolution shall become effective from and after the date of the filing of said document in the office of the Cascade County Clerk and Recorder.

PASSED AND ADOPTED by the City Commission of the City of Great Falls, Montana, on this 6th day of June, 2017.

Bob Kelly, Mayor

ATTEST:

Lisa Kunz, City Clerk

(SEAL OF CITY)

APPROVED FOR LEGAL CONTENT:

Sara R. Sexe, City Attorney

Attachment "A"

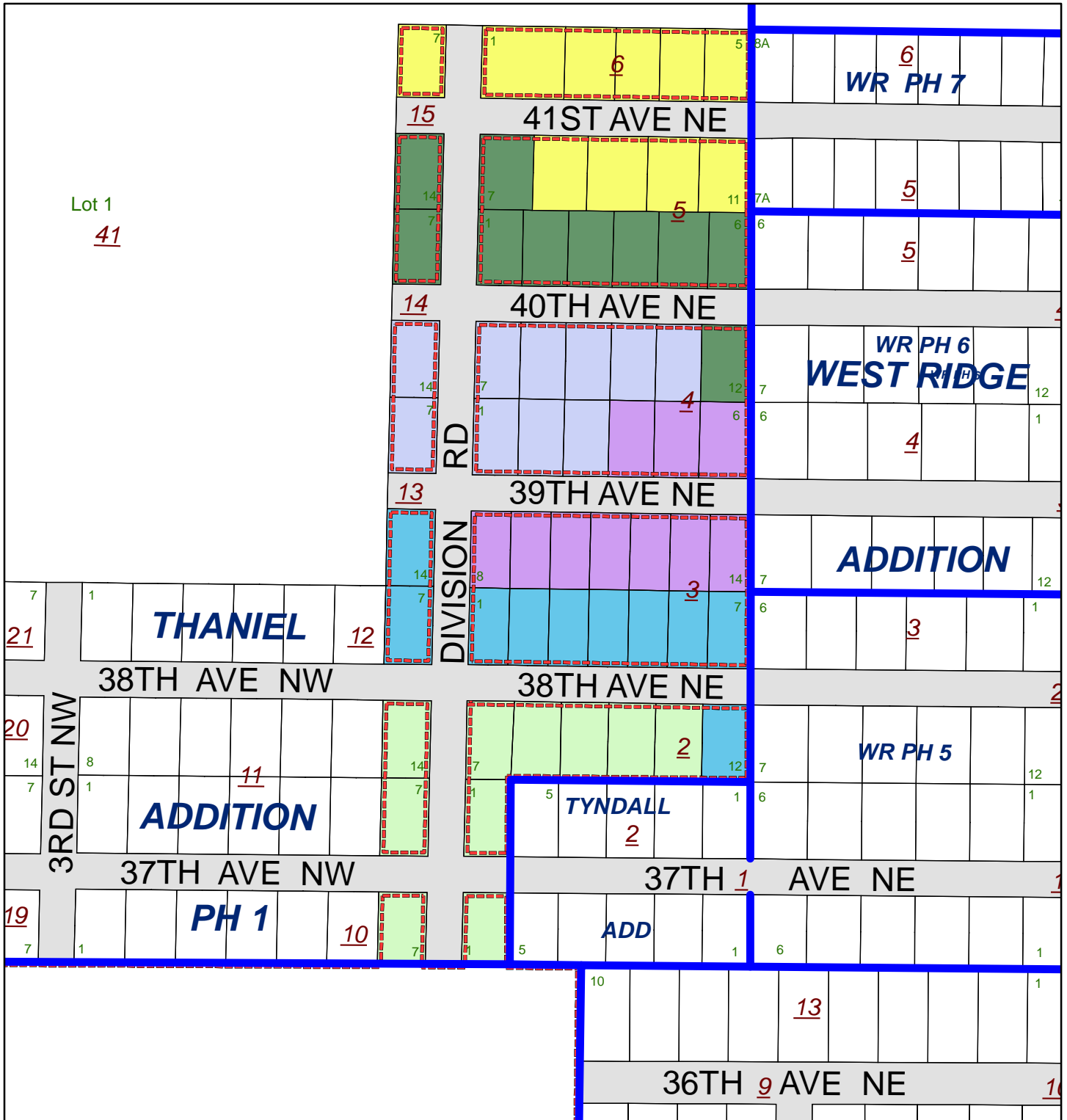

- Subdivision Line
- City Limits
- Tracts of Land
- Right-of-Way
- Phase 1 Build-Resolution 10174
- Phase 2 Build-Resolution 10175
- Phase 3 Build-Resolution 10176
- Phase 4 Build-Resolution 10177
- Phase 5 Build-Resolution 10178
- Phase 6 Build-Resolution 10179

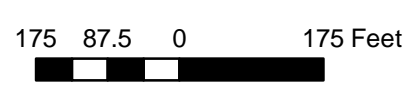

Thanie Addition Major Subdivision Phase 1
Phased Annexations