

RESOLUTION 9916

A RESOLUTION BY THE CITY COMMISSION OF THE CITY OF GREAT FALLS, MONTANA, TO EXTEND THE BOUNDARIES OF SAID CITY TO INCLUDE CASTLE PINES ADDITION, PHASE IX, AND A SEGMENT OF 13TH STREET SOUTH, **EXCEPT FOR LOTS 1 – 6, BLOCK 2, AND LOTS 1 – 4, BLOCK 3**, IN G.L.O. LOT 1, SECTION 19, TOWNSHIP 20 NORTH, RANGE 4 EAST, P.M.M., CASCADE COUNTY, MONTANA, MORE PARTICULARLY DESCRIBED HEREINBELOW; ALL AS SHOWN ON THE MAP ATTACHED HERETO MARKED ATTACHMENT “A” AND BY THIS REFERENCE MADE A PART HEREOF.

* * * * *

WHEREAS, the City of Great Falls is a city incorporated under the laws of the State of Montana, and having a population of more than ten thousand (10,000) is a city of the first class; and,

WHEREAS, there is contiguous to said City, but without the boundaries thereof, certain tracts or parcels of land situated in the County of Cascade, State of Montana, and described as follows:

Castle Pines Addition, Phase IX, **except for Lots 1 – 6, Block 2 and Lots 1 – 4, Block 3, Castle Pines Addition, Phase IX**, in G.L.O. Lot 1, Section 19, Township 20 North, Range 4 East, P.M.M., Cascade County, Montana and containing –1.294 acres;

and,

A segment of 13th Street South, in the vicinity of 29th Avenue South, in G.L.O. Lot 1, Section 19, Township 20 North, Range 4 East, and Northeast ¼ Section 24, Township 20 North, Range 3 East P.M.M. Cascade County, Montana, described as follows:

Commencing at the Southwest corner of Castle Pines Addition, Phase VI, being the true point of beginning;

Thence South along easterly right-of-way line of 13th Street South, a distance of 853.71 feet to a point which is on the easterly right-of-way line of 13th Street South;

Thence West a distance of 60 feet to a point on the westerly right-of-way line of 13th Street South;

Thence North a distance of 853.71 feet along the westerly right-of-way line of 13th Street South and parallel with and 30 feet westerly of the east section line of Section 24, Township 20 North, Range 3 East, to a point on the westerly right-of-way line of 13th Street South;

Thence East a distance of 60 feet to the point of beginning and containing 1.76 acres more or less;

containing in all 3.054 acres more or less as shown on the attached as Attachment "A" and by this reference made a part hereof, and according to the final plat of Castle Pines Addition, Phase IX.

WHEREAS, Section 7-2-4601, Montana Code Annotated, provides that whenever the owners of real property contiguous to any incorporated city of the first class petition to have said property made a part of the municipal corporation, such lands may be embraced within the corporate limits thereof and the boundaries of such city of the first class extended so as to include the same; and,

WHEREAS, the owner of the hereinabove described property has submitted a petition to have said property annexed to the City of Great Falls.

NOW, THEREFORE, the City Commission now finds that it is to the best interest of the City of Great Falls and its inhabitants to proceed with the incorporation of said territory into the City of Great Falls; and,

WHEREAS, all of the proceedings herein have been conducted in strict compliance with and in conformity to the law and constitution of the State of Montana, and all conditions, acts, and things required to be done precedent to and in the passage and adoption of this resolution have been properly and legally done, and performed;

NOW, THEREFORE, BE IT RESOLVED BY THE COMMISSION OF THE CITY OF GREAT FALLS, MONTANA;

That the boundaries of the City of Great Falls, Montana, be and the same are hereby extended so as to embrace and include within the corporate limits of said city all of the land hereinabove described, included as: "CASTLE PINES ADDITION, PHASE IX, AND A SEGMENT OF 13TH STREET SOUTH, **EXCEPT FOR LOTS 1 – 6, BLOCK 2, AND LOTS 1 – 4, BLOCK 3**, IN G.L.O. LOT 1, SECTION 19, TOWNSHIP 20 NORTH, RANGE 4 EAST, P.M.M., CASCADE COUNTY, MONTANA."

BE IT FURTHER RESOLVED BY THE COMMISSION OF THE CITY OF GREAT FALLS, MONTANA:

That the Cascade County Clerk and Recorder is hereby authorized and directed to change the appropriate district boundaries of the City of Great Falls, Montana, to include said tract of land; and,

That this Resolution shall become effective from and after the date of the filing of said document in the office of the Cascade County Clerk and Recorder.

PASSED AND ADOPTED by the City Commission of the City of Great Falls, Montana, on this 5th day of April, 2011.

Michael J. Winters, Mayor

ATTEST:

Lisa Kunz, City Clerk





(SEAL OF CITY)

APPROVED FOR LEGAL CONTENT:

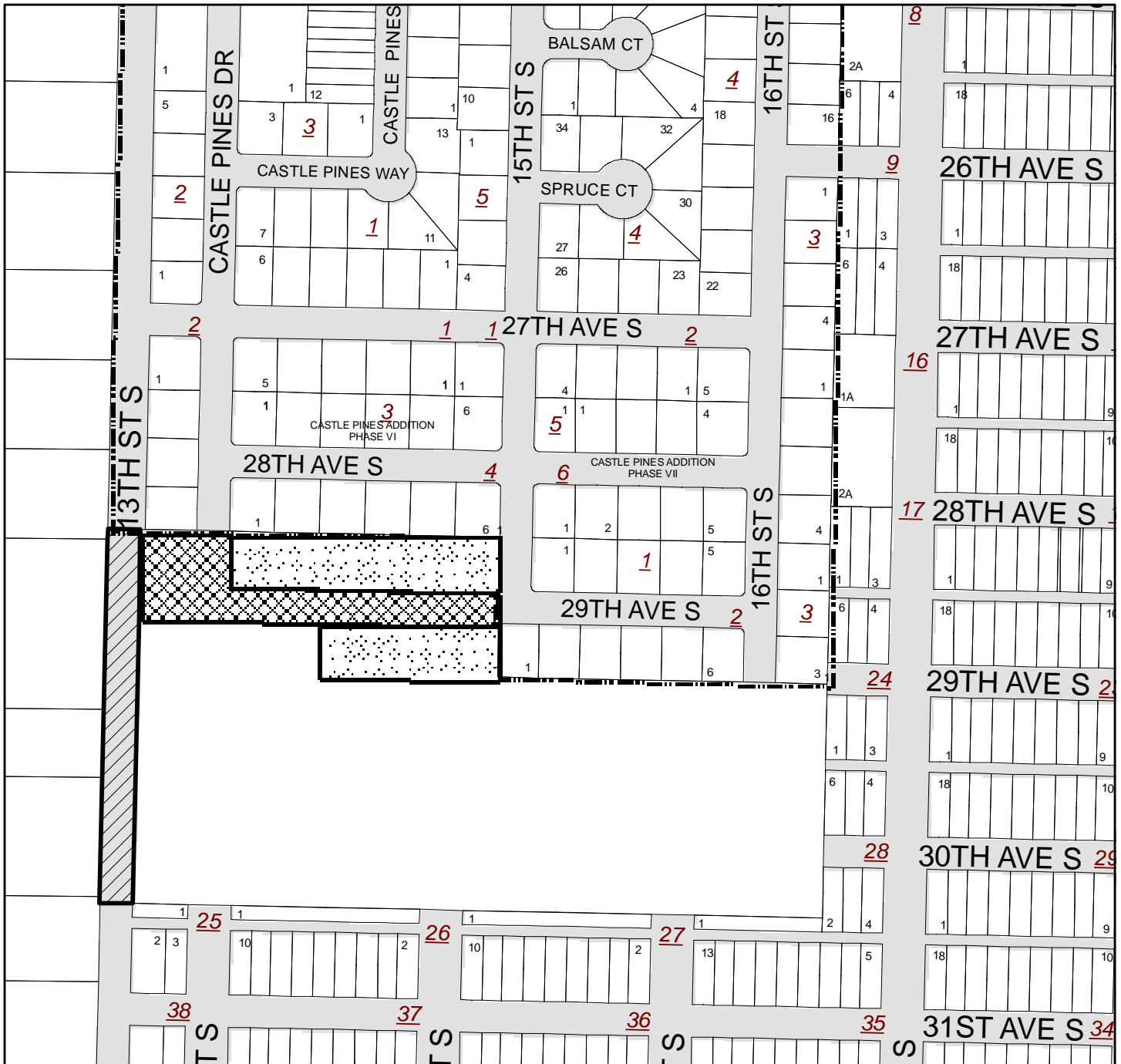
James W. Santoro, City Attorney

RESOLUTION 9916 ATTACHMENT "A"



-  PROPERTY DESCRIBED IN RESOLUTION 9916
-  SEGMENT OF 13TH STREET SOUTH DESCRIBED IN RESOLUTION 9916
-  PROPERTY DESCRIBED IN RESOLUTION 9917
-  CITY LIMITS

