

RESOLUTION NO. 9565

A RESOLUTION BY THE CITY COMMISSION OF THE CITY OF GREAT FALLS, MONTANA, TO EXTEND THE BOUNDARIES OF SAID CITY TO INCLUDE 2.00 ACRES OF LAND IN THE NW1/4NW1/4 OF SECTION 17, TOWNSHIP 20 NORTH, RANGE 4 EAST, P.M.M., CASCADE COUNTY, MONTANA, TO THE CITY OF GREAT FALLS, MONTANA; MORE PARTICULARLY DESCRIBED HEREINBELOW; ALL AS SHOWN ON THE MAP ATTACHED HERETO MARKED EXHIBIT "A" AND BY THIS REFERENCE MADE A PART HEREOF.

* * * * *

WHEREAS, the City of Great Falls is a city incorporated under the laws of the State of Montana, and having a population of more than ten thousand (10,000) is a city of the first class; and,

WHEREAS, the following described unincorporated properties are wholly surrounded by said City of Great Falls:

Two tracts of land in the NW1/4NW1/4 Section 17, Township 20 North, Range 4 East, P.M.M., Cascade County, Montana, more fully described as follows: Beginning at the NE corner of COS #1991 the true point of beginning; thence S00°02'E, 209.00 feet; thence N89°56'W, 418.00 feet; thence N00°02'W, 209.00 feet; thence S89°56'E, 418.00 feet to the true point of beginning, containing in all 2.00 acres more or less; all as described on a survey document filed August 13, 1999, in the Clerk and Recorder's Office of Cascade County, Montana, under CS# 3674;

all as shown on the map attached hereto marked Exhibit "A" and by this reference made a part hereof; and,

WHEREAS, Section 7-2-4501, Montana Code Annotated, provides a city may include as part of the city any platted or unplatted tract or parcel of land that is wholly surrounded by the city.

WHEREAS, in the judgement of the City Commission of said City, expressed by Resolution No. 9561 entitled:

A RESOLUTION OF INTENTION BY THE CITY COMMISSION OF THE CITY OF GREAT FALLS, MONTANA, TO EXTEND THE BOUNDARIES OF SAID CITY TO INCLUDE 2.00 ACRES OF LAND IN THE NW1/4NW1/4 OF SECTION 17, TOWNSHIP 20 NORTH, RANGE 4 EAST, P.M.M., CASCADE COUNTY, MONTANA, AND DIRECTING NOTICE TO BE GIVEN BY THE CITY CLERK AS PROVIDED BY LAW.

duly and regularly passed and adopted on the 4th day of April, 2006, stating that it will be in the best interest of said city and the inhabitants thereof, that the boundaries of said City of Great Falls shall be extended so as to include "TWO TRACTS OF LAND CONSISTING OF 2.00 ACRES LEGALLY DESCRIBED AS PARCEL MARK NOS. 10 AND 10B IN THE NW1/4NW1/4 OF SECTION 17, TOWNSHIP 20 NORTH, RANGE 4 EAST, P.M.M., CASCADE COUNTY, MONTANA, AS DESCRIBED ON A SURVEY DOCUMENT FILED AUGUST 13, 1999, IN THE CLERK AND RECORDER'S OFFICE OF CASCADE COUNTY, MONTANA, UNDER CS# 3674."

WHEREAS, the City Clerk of said City, pursuant to said Resolution and the statute in such case made and provided, forthwith caused to be published in the Great Falls Tribune, the newspaper published nearest said tract of land, at least once a week for two (2) successive weeks, a notice to the effect that said Resolution had been duly and regularly passed, and that for a period of twenty (20) days after the first publication of said notice, said City Clerk would receive expressions of approval or disapproval, in writing, of the said proposed extension of the boundaries of said City, and also stating therein the time and place set for the public hearing provided by said Resolution; and,

WHEREAS, the first publication of said notice hereinbefore referred to was the 9th day of April, 2006; and,

WHEREAS, a public hearing was held by the City Commission of the City of Great Falls on May 2, 2006, at 7:00 P.M., in the Commission Chambers of the Great Falls Civic Center, where said Commission heard all persons and all things relative to the proposed annexation of said property;

NOW, THEREFORE, the City Commission now finds that it is to the best interest of the City of Great Falls and its inhabitants to proceed with the incorporation of said territory into the City of Great Falls; and,

WHEREAS, all of the proceedings herein have been conducted in strict compliance with and in conformity to the law and constitution of the State of Montana, and all conditions, acts, and things required to be done precedent to and in the passage and adoption of this resolution have been properly and legally done, and performed;

NOW, THEREFORE, BE IT RESOLVED BY THE COMMISSION OF THE CITY OF GREAT FALLS, MONTANA;

That the boundaries of the City of Great Falls, Montana, be and the same are hereby extended so as to embrace and include within the corporate limits of said city all of the land hereinabove described, included as: "TWO TRACTS OF LAND CONSISTING OF 2.00 ACRES LEGALLY DESCRIBED AS PARCEL MARK NOS. 10 AND 10B IN THE NW1/4NW1/4 OF SECTION 17, TOWNSHIP 20 NORTH, RANGE 4 EAST, P.M.M., CASCADE COUNTY, MONTANA, AS DESCRIBED ON A SURVEY DOCUMENT FILED AUGUST 13, 1999, IN THE CLERK AND RECORDER'S OFFICE OF CASCADE COUNTY, MONTANA, UNDER CS# 3674."

BE IT FURTHER RESOLVED BY THE COMMISSION OF THE CITY OF GREAT FALLS, MONTANA:

The Cascade County Clerk and Recorder is hereby authorized and directed to change the appropriate district boundaries of the City of Great Falls, Montana, to include said tracts of land; and,

BE IT FURTHER RESOLVED BY SAID CITY COMMISSION that this Resolution shall become effective July 5, 2006.

PASSED AND ADOPTED by the City Commission of the City of Great Falls, Montana, on this 2nd day of May, 2006.

Dona R. Stebbins, Mayor

ATTEST:

Peggy J. Bourne, City Clerk

(SEAL OF CITY)

APPROVED FOR LEGAL CONTENT:

David V. Gliko, City Attorney

State of Montana)
County of Cascade :ss
City of Great Falls)

I, Peggy J. Bourne, City Clerk of the City of Great Falls, Montana, do hereby certify that the foregoing Resolution No. 9565 was placed on its final passage and approved by the Commission of the City of Great Falls, Montana, at a meeting thereof held on the 2nd day of May, 2006.

IN WITNESS WHEREOF, I have hereunto set my hand and affixed the Seal of said City this 2nd day of May, 2006.

Peggy J. Bourne, City Clerk

(SEAL OF CITY)

PROPOSED TRACTS OF LAND TO BE ANNEXED
INTO THE CITY OF GREAT FALLS

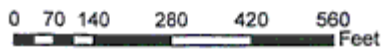
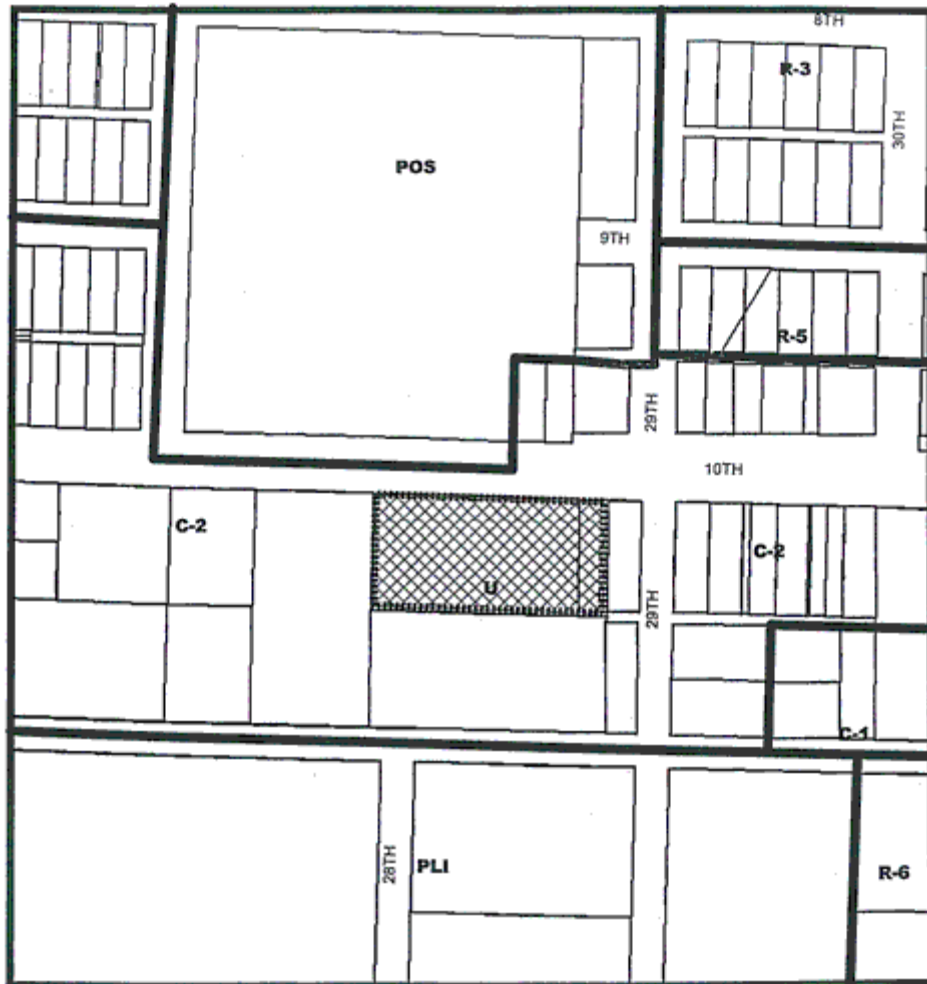

Legend

- CITY LIMITS
- ▨ PROPERTY TO BE ANNEXED TO CITY

EXHIBIT "A"