

RESOLUTION NO. 9471

A RESOLUTION BY THE CITY COMMISSION OF THE CITY OF GREAT FALLS, MONTANA, TO EXTEND THE BOUNDARIES OF SAID CITY TO INCLUDE SKYLINE PARK ADDITION, PHASE 11, LOCATED IN THE S1/2 SE1/4 OF SECTION 26, TOWNSHIP 21 NORTH, RANGE 3 EAST, P.M.M., CASCADE COUNTY, MONTANA, MORE PARTICULARLY DESCRIBED HEREINBELOW; ALL AS SHOWN ON THE MAP ATTACHED HERETO MARKED EXHIBIT "A" AND BY THIS REFERENCE MADE A PART HEREOF.

* * * * *

WHEREAS, the City of Great Falls is a city incorporated under the laws of the State of Montana, and having a population of more than ten thousand (10,000) is a city of the first class; and,

WHEREAS, there is contiguous to said City, but without the boundaries thereof, certain tracts or parcels of land situated in the County of Cascade, State of Montana, and described as follows:

Skyline Park Addition, Phase 11, located in the S1/2 SE1/4 of Section 26, Township 21 North, Range 3 East, P.M.M., Cascade County, Montana, and containing 6.318 acres,

all as shown on the map attached hereto marked Exhibit "A" and by this reference made a part hereof, and according to the final plat of Skyline Park Addition, Phase 11; and,

WHEREAS, Section 72-4601, Montana Code Annotated, provides that whenever the owners of real property contiguous to any incorporated city of the first class petition to have said property made a part of the municipal corporation, such lands may be embraced within the corporate limits thereof and the boundaries of such city of the first class extended so as to include the same; and,

WHEREAS, the owner of the hereinabove described property has submitted a petition to have said property annexed to the City of Great Falls.

NOW, THEREFORE, the City Commission now finds that it is to the best interest of the City of Great Falls and its inhabitants to proceed with the incorporation of said territory into the City of Great Falls; and,

WHEREAS, all of the proceedings herein have been conducted in strict compliance with and in conformity to the law and constitution of the State of Montana, and all conditions, acts, and things required to be done precedent to and in the passage and adoption of this resolution have been properly and legally done, and performed;

NOW, THEREFORE, BE IT RESOLVED BY THE COMMISSION OF THE CITY OF GREAT FALLS, MONTANA;

That the boundaries of the City of Great Falls, Montana, be and the same are hereby extended so as to embrace and include within the corporate limits of said city all of the land hereinabove described, included as: "SKYLINE PARK ADDITION, PHASE 11, LOCATED

IN THE S1/2 SE1/4 OF SECTION 26, TOWNSHIP 21 NORTH, RANGE 3 EAST, P.M.M.,
CASCADE COUNTY, MONTANA.”

BE IT FURTHER RESOLVED BY THE COMMISSION OF THE CITY OF GREAT
FALLS, MONTANA:

The Cascade County Clerk and Recorder is hereby authorized and directed to change the
appropriate district boundaries of the City of Great Falls, Montana, to include said tract of land;
and,

BE IT FURTHER RESOLVED BY SAID CITY COMMISSION that this Resolution
shall become effective from and after the date of the filing of said document in the office of the
Cascade County Clerk and Recorder.

PASSED AND ADOPTED by the City Commission of the City of Great Falls, Montana,
on this 3rd day of May, 2005.

Randall H. Gray, Mayor

ATTEST:

Carolyn M. Horst, Deputy City Clerk

(SEAL OF CITY)

Approved for legal content:

City Attorney

State of Montana)
County of Cascade :ss
City of Great Falls)

I, Carolyn M. Horst, Deputy City Clerk of the City of Great Falls, Montana, do hereby
certify that the foregoing Resolution No. 9471 was placed on its final passage by the Commission
of the City of Great Falls, Montana, at a meeting thereof held on the 3rd day of May, 2005, and
approved by the Mayor of said City on the 3rd day of May, 2005.

IN WITNESS WHEREOF, I have hereunto set my hand and affixed the Seal of said City
this 3rd day of May, 2005.

Carolyn M. Horst, Deputy City Clerk

(SEAL OF CITY)

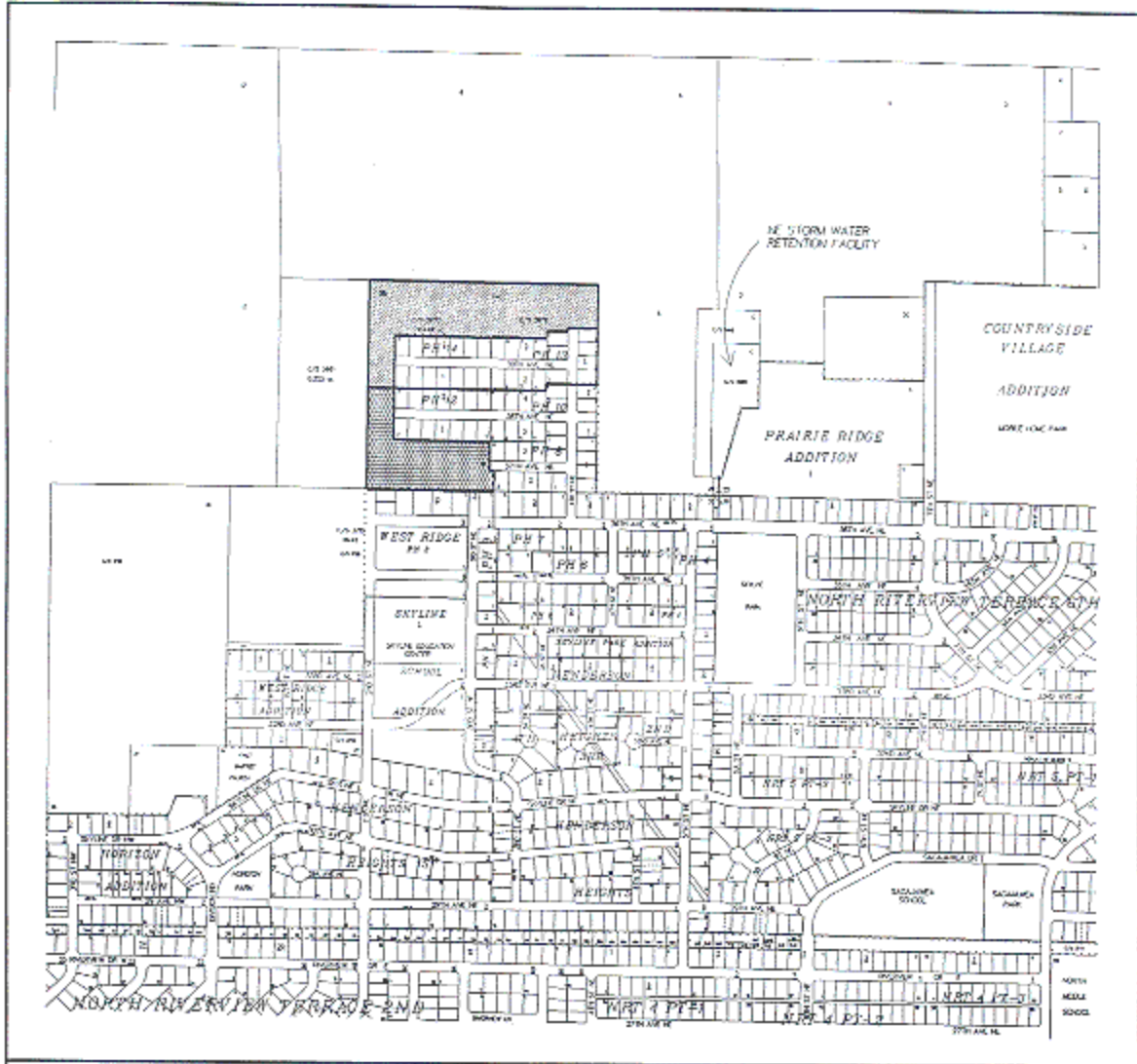

"VICINITY MAP"



FINAL PLAT SKYLINE PARK ADDITION PHASE 11



REMAINDER OF PRELIMINARY PLAT SKYLINE PARK ADDITION



EXISTING CITY LIMITS

ZONING - ALL INCORPORATED PROPERTY IN THE VICINITY IS "A" RESIDENTIAL WITH THE EXCEPTION OF COUNTRYSIDE VILLAGE WHICH IS "MH" MOBILE HOME DISTRICT AND A PORTION OF WEST RIDGE PHASE 1 WHICH IS "PUD" PLAN UNIT DEVELOPMENT

- COUNTY ZONING SURROUNDING SUBDIVISION SITE IS "R-2" LOW DENSITY RESIDENTIAL



6/1/2004