

RESOLUTION NO. 9470

A RESOLUTION OF INTENTION BY THE CITY COMMISSION OF THE CITY OF GREAT FALLS, MONTANA, TO EXTEND THE BOUNDARIES OF SAID CITY TO INCLUDE BEEBE TRACT 35B AND A SEGMENT OF 57TH STREET NORTH IN THE NW1/4 OF SECTION 10, TOWNSHIP 20 NORTH, RANGE 4 EAST, P.M.M., CASCADE COUNTY, MONTANA, DIRECTING NOTICE TO BE GIVEN BY THE CITY CLERK AS PROVIDED BY LAW.

* * * * *

WHEREAS, the City of Great Falls is a city incorporated under the laws of the State of Montana, and having a population of more than ten thousand (10,000) is a city of the first class; and,

WHEREAS, there is contiguous to said City, but without the boundaries thereof, two tracts of land situated in the NW1/4 of Section 10, Township 20 North, Range 4 East, P.M.M., County of Cascade, State of Montana, and described as follows:

? Beebe Tract 35B, more particularly described as follows: beginning at a point on the North boundary line of said Section 10, which point bears North 88°14' East a distance of 1192.1 feet from the Northwest corner of said Section 10; thence South 2°45' East 505.9 feet to a point, the true point of beginning; thence South 2°45' East 150.2 feet to a point on the North boundary line of the former Great Falls-Belt Highway, which highway is now known as the highway to Malmstrom Air Force Base; thence North 88°38' East along the Northerly boundary line of said highway a distance of 77.8 feet; thence North 42°58' East a distance of 69.9 feet to a point; thence North 2°45' West a distance of 100.2 feet to a point; thence South 88°38' West a distance of 127.8 feet to the point of beginning, containing 0.412 acres;

? Segment of 57th Street North Right-of-Way more particularly described as follows: beginning at the northwest corner of said Section 10, thence South 89°52'31" East, along the north boundary line of said Section 10, a distance of 1321.03 feet, to the westerly right-of-way of said 57th Street North and true point of beginning; thence South 89°52'31" East along said north boundary line, a distance of 100.00 feet to the easterly right-of-way of said street; thence South 00°53'36" East, along said easterly right-of-way, a distance of 587.72 feet; thence South 36°26'28" East along said easterly right-of-way, a distance of 86.56 feet; thence North 89°43'31" West, a distance of 199.93 feet to a point on the westerly right-of-way of 57th Street North; thence North 48°50'41" East, along said westerly right-

of-way, a distance of 70.31 feet; thence North 00°53'36" West, along said westerly right-of-way, a distance of 606.76 feet to the point of beginning and containing 1.57 acres;

generally as shown on the vicinity map exhibit attached hereto marked Exhibit "A" and by this reference made a part hereof; and,

WHEREAS, Section 7-2-4402, Montana Code Annotated, provides that whenever any land contiguous to a municipality is owned by the state of Montana or a political subdivision of the state, such land may be incorporated and included in the municipality to which it is contiguous; and,

WHEREAS, Section 7-2-4601, Montana Code Annotated, provides that whenever the owners of real property contiguous to any incorporated city of the first class petition to have said property made a part of the municipal corporation, such lands may be embraced within the corporate limits thereof and the boundaries of such city of the first class extended so as to include the same.

NOW, THEREFORE, BE IT RESOLVED BY THE COMMISSION OF THE CITY OF GREAT FALLS, MONTANA;

That in its judgment it will be to the best interest of said City of Great Falls and the inhabitants thereof, that the boundaries of said City of Great Falls shall be extended so as to include: "BEEBE TRACT 35B AND A SEGMENT OF 57TH STREET NORTH IN THE NW1/4 OF SECTION 10, TOWNSHIP 20 NORTH, RANGE 4 EAST, P.M.M., CASCADE COUNTY, MONTANA."

BE IT FURTHER RESOLVED BY SAID CITY COMMISSION: That Tuesday, the 3rd day of May, 2005, at 7:00 P.M., in the Commission Chambers at the Great Falls Civic Center, Great Falls, Montana, be and the same is hereby set as the time and place for a public hearing at which time the Great Falls City Commission shall hear all persons and all things relative to the proposed annexation of 'BEEBE TRACT 35B AND A SEGMENT OF 57TH STREET NORTH IN THE NW1/4 OF SECTION 10, TOWNSHIP 20 NORTH, RANGE 4 EAST, P.M.M., CASCADE COUNTY, MONTANA.'

BE IT FURTHER RESOLVED BY SAID CITY COMMISSION that the City Clerk of said City shall, at the aforesaid public hearing before the said City Commission and after expiration of a twenty (20) day period following the first publication of notice of passage of this Resolution, lay before the City Commission all communications in writing by her so received pertaining to said annexation.

PASSED AND ADOPTED by the City Commission of the City of Great Falls, Montana, on this 5th day of April, 2005.

Randall H. Gray, Mayor

ATTEST:

Carolyn M. Horst, Deputy City Clerk

(SEAL OF CITY)

Approved for legal content: City Attorney

State of Montana)
County of Cascade :ss
City of Great Falls)

I, Carolyn M. Horst, Deputy City Clerk of the City of Great Falls, Montana, do hereby certify that the foregoing Resolution No. 9470 was placed on its final passage by the Commission of the City of Great Falls, Montana, at a meeting thereof held on the 5th day of April, 2005, and approved by the Mayor of said City on the 5th day of April, 2005.

IN WITNESS WHEREOF, I have hereunto set my hand and affixed the Seal of said City this 5th day of April, 2005.

Carolyn M. Horst, Deputy City Clerk

(SEAL OF CITY)

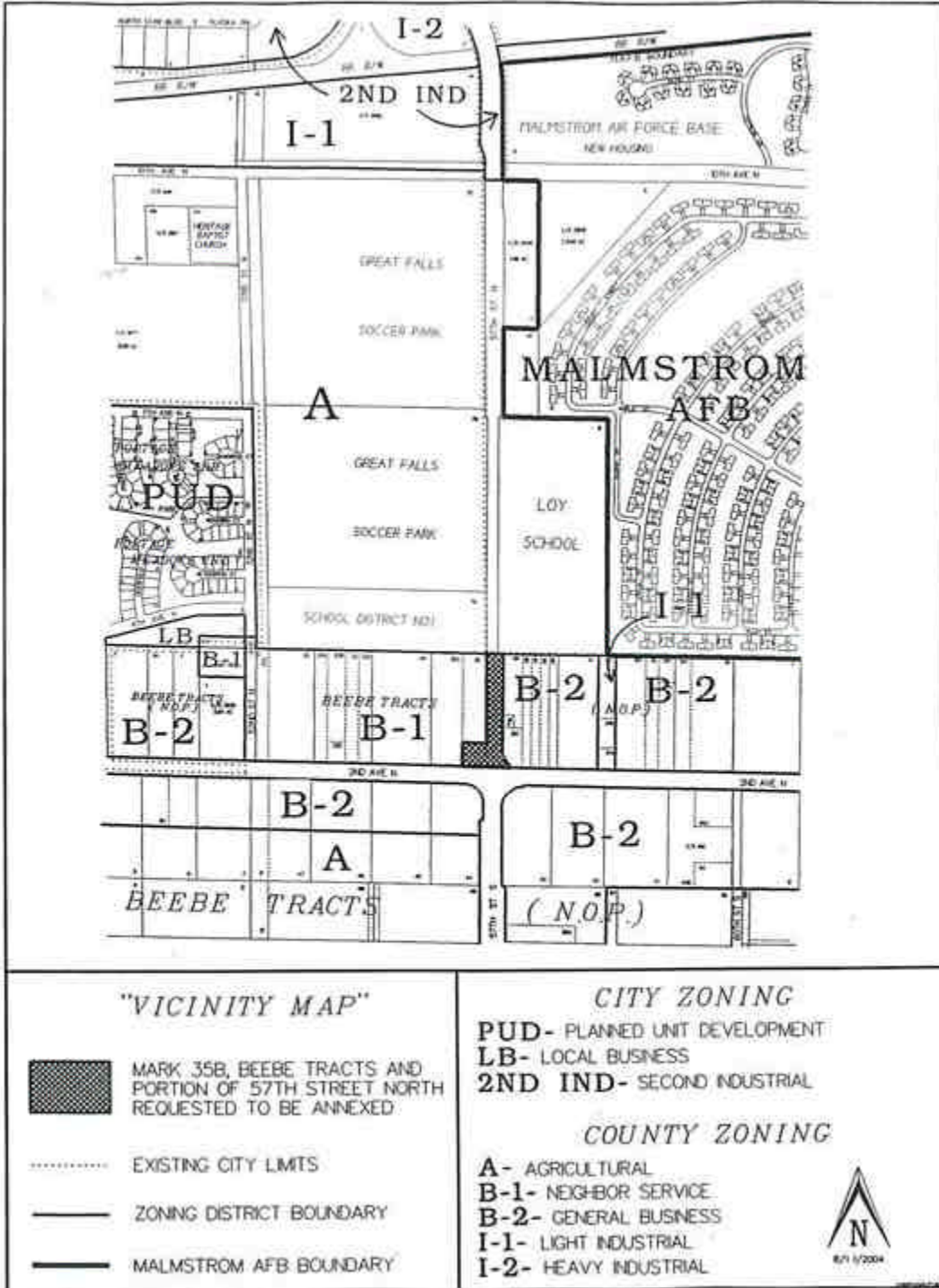

EXHIBIT "A"