

CORRECTED RESOLUTION 9456

A RESOLUTION BY THE CITY COMMISSION OF THE CITY OF GREAT FALLS, MONTANA, TO EXTEND THE BOUNDARIES OF SAID CITY TO INCLUDE LOT 1, BLOCK 2, ~~FIRST ADDITION TO GREAT FALLS ADDITION~~, **FIRST ADDITION TO GREAT FALLS CLINIC ADDITION**, LOCATED IN THE NW¼ OF SECTION 17, TOWNSHIP 20 NORTH, RANGE 4 EAST, P.M.M., CASCADE COUNTY, MONTANA, MORE PARTICULARLY DESCRIBED HEREINBELOW; ALL AS SHOWN ON THE MAP ATTACHED HERETO MARKED EXHIBIT "A" AND BY THIS REFERENCE MADE A PART HEREOF.

\* \* \* \* \*

WHEREAS, the City of Great Falls is a city incorporated under the laws of the State of Montana, and having a population of more than ten thousand (10,000) is a city of the first class; and,

WHEREAS, there is contiguous to said City, but without the boundaries thereof, certain tracts or parcels of land situated in the County of Cascade, State of Montana, and described as follows:

Lot 1, Block 2, ~~First Addition To Great Falls Addition~~, **First Addition to Great Falls Clinic Addition**, located in the NW¼ of Section 17, Township 20 North, Range 4 East, P.M.M., Cascade County, Montana and containing 8.04 acres, as shown on the attached Exhibit "A" and by this reference made a part hereof, and according to the final plat of First Addition to Great Falls Clinic Addition.

WHEREAS, Section 7-2-4601, Montana Code Annotated, provides that whenever the owners of real property contiguous to any incorporated city of the first class petition to have said property made a part of the municipal corporation, such lands may be embraced within the corporate limits thereof and the boundaries of such city of the first class extended so as to include the same; and,

WHEREAS, the owner of the hereinabove described property has submitted a petition to have said property annexed to the City of Great Falls.

NOW, THEREFORE, the City Commission now finds that the herein requested annexation meets the criteria cited in Section 17.16.7.050 of the Unified Land Development Code of the City of Great Falls

and that it is to the best interest of the City of Great Falls and its inhabitants to proceed with the incorporation of said territory into the City of Great Falls; and,

WHEREAS, all of the proceedings herein have been conducted in strict compliance with and in conformity to the law and constitution of the State of Montana, and all conditions, acts, and things required to be done precedent to and in the passage and adoption of this resolution have been properly and legally done, and performed;

NOW, THEREFORE, BE IT RESOLVED BY THE COMMISSION OF THE CITY OF GREAT FALLS, MONTANA;

That the boundaries of the City of Great Falls, Montana, be and the same are hereby extended so as to embrace and include within the corporate limits of said city all of the land hereinabove described, included as: "LOT 1, BLOCK 2, ~~FIRST ADDITION TO GREAT FALLS ADDITION~~, **FIRST ADDITION TO GREAT FALLS CLINIC ADDITION**, LOCATED IN THE NW¼ OF SECTION 17, TOWNSHIP 20 NORTH, RANGE 4 EAST, P.M.M., CASCADE COUNTY, MONTANA."

BE IT FURTHER RESOLVED BY THE COMMISSION OF THE CITY OF GREAT FALLS, MONTANA:

The Cascade County Clerk and Recorder is hereby authorized and directed to change the appropriate district boundaries of the City of Great Falls, Montana, to include said tracts of land; and,

BE IT FURTHER RESOLVED BY SAID CITY COMMISSION that this Resolution shall become effective from and after the date of the filing of said document in the office of the Cascade County Clerk and Recorder.

PASSED AND ADOPTED by the City Commission of the City of Great Falls, Montana, on this 5<sup>th</sup> day of January, 2010.

\_\_\_\_\_  
Michael J. Winters, Mayor

ATTEST:

\_\_\_\_\_  
Lisa Kunz, City Clerk

(CITY SEAL)

APPROVED FOR LEGAL CONTENT:

\_\_\_\_\_  
City Attorney

# VICINITY MAP

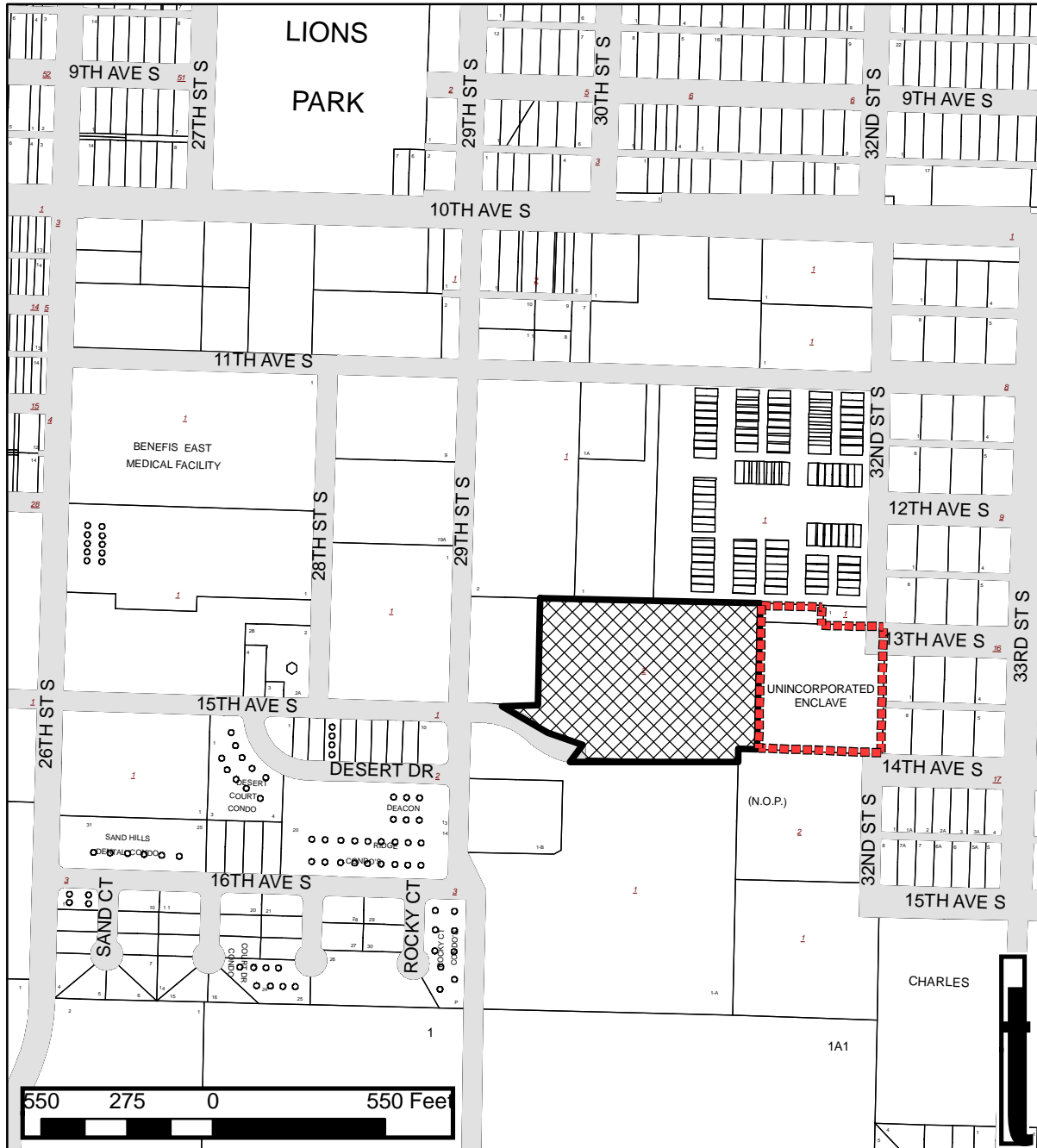

 SUBJECT LOT 1, BLOCK 2, FIRST ADDITION TO GREAT FALLS CLINIC ADDITION

 City Limits

EXHIBIT "A"