

RESOLUTION NO. 9378

A RESOLUTION OF THE CITY COMMISSION OF THE CITY OF GREAT FALLS, MONTANA, DECLARING IT TO BE THE INTENTION OF THE CITY OF GREAT FALLS TO CREATE SPECIAL LIGHTING DISTRICT – INDUSTRIAL LIGHTING “SLD-I” NO. 1298 TO INCLUDE PROPERTIES LOCATED WITHIN THE NORTH PARK ADDITION

WHEREAS:

- A.** Pursuant to MCA 7-12-4301 the City of Great Falls is authorized to create special improvement districts embracing any street or streets or public highway therein or portion thereof and property adjacent thereto or property which may be declared by said city commission to be benefited by the improvements to be made for the purpose of lighting such street or streets or public highway, and;
- B.** The City Commission of the City of Great Falls, Montana, recognizes a need for a special improvement lighting district for commercial/industrial properties within a designated Industrial/Agricultural Park or for commercial/industrial properties in excess of 52,500 square feet receiving lighting of a commercial/industrial nature, and;
- C.** Pursuant to MCA 7-12-4302 the City Commission must pass a resolution of intention before creating any special improvement lighting district, and;
- D.** It appears to be in the best interest of the City of Great Falls and the inhabitants thereof that the City Commission create a special improvement lighting district to be known as Special Lighting District – Industrial Lighting “SLD-I” No. 1298, and;
- E.** That the newly created boundaries of said Special Lighting District – Industrial Lighting “SLD-I” No. 1298 are as shown on the attached Exhibit “A” and are hereby declared to be further defined as follows:

Beginning at the intersection of the centerline of 38th Street North and the extended south line of U.S. Highway 87 By-Pass proceed east along the south line of U.S. Highway 87 By-Pass to the extended east boundary line of Lot 1, Block 1, North Park Addition; thence proceed north along the extended east boundary line of Lot 1, Block 1, North Park Addition to the northeast corner of said Lot 1, Block 1; thence proceed east along the north boundary line of Block 1 to the northeast corner of Block 1; thence proceed south along the east boundary line of Block 1 to its intersection with the south line of U.S. Highway 87 By-Pass; thence proceed east along the south line of U.S. Highway 87 By-Pass to the east boundary line of Lot 1, Block 4 of the North Park Addition; thence proceed south along the east boundary line of Lot 1, Block 4 to the south boundary line of the North Park Addition; thence proceed westerly along the south boundary line of the North Park Addition to its intersection with the centerline of 38th Street North; thence proceed north along the centerline of 38th Street North to its intersection with the south line of U.S. Highway

87 By-Pass and the point of beginning, and;

- F.** In accordance with MCA 7-12-4323 Assessment of costs. “the city council or commission may assess the entire cost of such improvement against the entire district, each lot or parcel of land within such district to be assessed for that part of the whole cost which its area bears to the area of in the entire, exclusive of streets, avenues, alleys and public places.”

The estimated annual cost of the district initially is \$18,366.80. This cost will be assessed to each lot or parcel within the special improvement district on an area basis as specified in this section. A listing of all parcels which will be included within the new Special Lighting District – Industrial Lighting “SLD-I” No. 1298 is attached as Exhibit “B”, and;

- G.** The general purpose of the district is provide for maintaining the existing lights and for supplying electrical current to the lights within the district, and;
- H.** That the City Commission of the City of Great Falls shall consider whether to pass a final resolution creating Special Lighting District – Industrial Lighting “SLD-I” No. 1298 as set forth herein at a meeting to be held on August 3, 2004 at 7:00 p.m., in the City Commission Chambers, 2 Park Drive South, Great Falls, Montana, and at the conclusion of said meeting the City Commission will consider a Resolution to create such district, and;
- I.** That the City Clerk is authorized and directed to give notice of this meeting in accordance with MCA 7-12-4303.

PASSED by the Commission of the City of Great Falls, Montana, on this 6th day of July, 2004.

Randall H. Gray, Mayor

ATTEST:

Carolyn Horst, Deputy City Clerk

(SEAL OF CITY)

Approved for Legal Content: City Attorney

State of Montana)
County of Cascade : ss
City of Great Falls)

I, Carolyn Horst, Deputy City Clerk of the City of Great Falls, Montana, do hereby certify that the foregoing Resolution 9378 was passed by the Commission of the City of Great Falls, Montana, at a meeting thereof held on the 6th day of July 2004, and approved by the Mayor of said City on the 6th day of July 2004.

IN WITNESS WHEREOF, I have hereunto set my hand and affixed the Seal of said City this 6th day of July 2004.

Carolyn Horst, Deputy City Clerk

(SEAL OF CITY)

LEGAL NOTICE

NOTICE IS HEREBY GIVEN that on the 6th day of July, 2004, the City Commission of the City of Great Falls, Montana, adopted a Resolution of Intent to Create No. 9378 entitled:

A RESOLUTION DECLARING IT TO BE THE INTENTION OF THE CITY COMMISSION OF THE CITY OF GREAT FALLS, MONTANA TO CREATE SPECIAL LIGHTING DISTRICT – INDUSTRIAL LIGHTING “SLD-I” NO. 1298 TO INCLUDE PROPERTIES LOCATED WITHIN THE NORTH PARK ADDITION

Resolution of Intent to Create No. 9378 is on file in the office of the City Clerk, Peggy J. Bourne, (406) 455-8541, Civic Center, 2 Park Drive, Great Falls, Montana, to which reference is hereby made for a full description of the boundaries of said district.

That the City Commission of the City of Great Falls, Montana, recognizes a need for a special improvement lighting district for commercial/industrial properties within a designated Industrial/Agricultural Park or for commercial/industrial properties in excess of 52,500 square feet receiving lighting of a commercial/industrial nature. The North Park Addition will be incorporated into the newly proposed Special Lighting District – Industrial Lighting “SLD-I” No. 1298. This will result in an estimated annual assessment in the newly created area of \$316.67 for an average lot of 87,166 square feet.

That the City Commission of the City of Great Falls, Montana, will be in session on the 6th day of July, 2004, at 7:00 o'clock p.m., in the Commission Chambers in the Civic Center, at which time and place the City Commission will hear objections to the intent to create said Industrial Lighting District No. 1298. Any person or persons, who are owners of any lot or parcel of land within said Special Lighting District – Industrial Lighting “SLD-I” No. 1298, who shall, within 15 days after the first publication of this notice have delivered to the City Clerk of the City of Great Falls, a protest in writing against the proposed creation of said special lighting district, shall have the right to appear at said meeting in person or by counsel, and show cause, if any there be, why such special lighting district should not be created.

Publication Dates: July 16, 2004 & July 23, 2004

*S.L.D.I. - 1298
SPECIAL LIGHTING
DISTRICT - INDUSTRIAL*

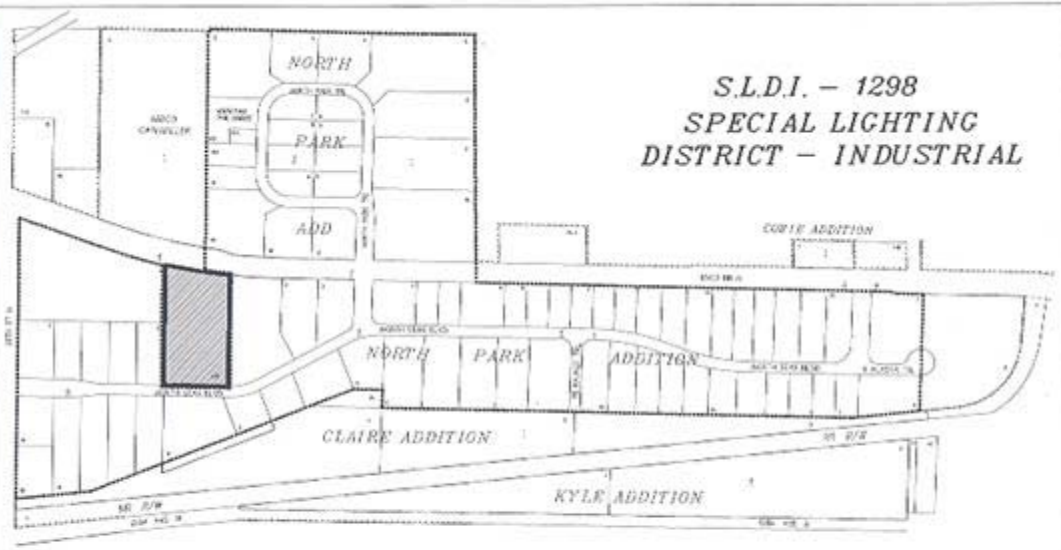

LEGEND

- LIGHTING DISTRICT BOUNDARY LINE
- OUTSIDE LIGHTING DISTRICT & OUTSIDE CITY LIMITS

DATE: 11/15/2011

EXHIBIT B

SPECIAL LIGHTING DISTRICT - INDUSTRIAL "SLD-I" 1298

48 - 250 WATT HPS ON 30' STEEL POLES WITH UNDERGROUND WIRING \$ 16,697.10

COST OF OPERATION AND ROUTINE MAINTENANCE	16,697.10
10% ADMINISTRATION FEE	<u>1,669.71</u>
TOTAL ANNUAL COST TO THE DISTRICT =	\$ 18,366.80

ASSESSMENT BASED ON 12 MONTHS -
ANNUAL ASSESSMENT FOR AN AVERAGE
87,166 SQ.FT. LOT IS \$316.67.

ANNUAL SQUARE FOOT COST = 0.003632949

PARCEL	BLOCK	LOT	SUB-DIVISION	NAME	PROPERTY ADDRESS	SET UP AREA (SQUARE FEET)	ANNUAL COST
1176300	1	2	North Park Addition	MCM Commercial Properties Inc.		129,068	468.90
1176400	1	3	North Park Addition	MCM Commercial Properties Inc.		71,482	259.69
1176600	1	4 - 5	North Park Addition	Minot Builders Supply Assn	4155 N. Park Trl	267,284	971.03
1176700	1	8	North Park Addition	Madison W Larry Etal		137,867	500.86
1176800	1	9	North Park Addition	B & W Investments	4169 N. Park Trl	155,901	566.38
1176900	1	10	North Park Addition	Hoven Brian E	4181 N. Park Trl	217,800	791.26
1177000	1	13	North Park Addition	Tonkovich Fred T Etal	4100 N. Park Trl	66,647	242.13
1177100	1	14	North Park Addition	Dige Robert D & Rita R	4108 N. Park Trl	71,221	258.74
1177200	1	15	North Park Addition	Great Falls Christian Center	4114 N. Park Trl	116,044	421.58
1177300	1	16 - 16A	North Park Addition	Schwan's Sales Enterprises Inc.	4122 N. Park Trl	68,172	247.67
1177500	1	17A	North Park Addition	MCM Commercial Properties Inc.	4126 N. Park Trl	51,313	186.42
1177600	2	1	North Park Addition	Gray Mark	4129 N. Park Trl	33,280	120.90
1177800	2	2 - 3	North Park Addition	North Montana Avenue Partnership	4144 N. Park Trl	69,696	253.20
1177900	2	4	North Park Addition	Baker Charles C	4166 N. Park Trl	36,416	132.30
1178000	2	5	North Park Addition	Macklin James E & Marilyn		35,850	130.24
1178100	2	6 - 7	North Park Addition	Great Falls Christian Center	4109 N. Park Trl	69,696	253.20
1178300	2	8	North Park Addition	Swanson Dale T	4125 N. Park Trl	36,416	132.30
1178400	3	1	North Park Addition	Anderson Morris D	4300 N. Star Blvd	57,064	207.31
1178500	3	2	North Park Addition	Byrne Investments LLC	4301 N. Star Blvd	28,793	104.60
1178600	3	3	North Park Addition	Lindstrom Paul H & Sharon A	4307 N. Star Blvd	28,793	104.60
1178700	3	4	North Park Addition	Patterson Bob Enterprises Inc.	4313 N. Star Blvd	57,586	209.21
1178900	3	6	North Park Addition	Bob Patterson Enterprises Inc.	4407 N. Star Blvd	28,793	104.60
1179000	3	7 - 9	North Park Addition	Lindstrom Paul H & Sharon A	4415 N. Star Blvd	86,379	313.81
1179100	3	10	North Park Addition	Brandt Lola M	4501 N. Star Blvd	28,967	105.24
1179200	3	11	North Park Addition	Neil John A	4509 N. Star Blvd	30,187	109.67
1179300	3	12	North Park Addition	Neil John A & Kay Leann		37,374	135.78

EXHIBIT B

SPECIAL LIGHTING DISTRICT - INDUSTRIAL "SLD-I" 1298

48 - 250 WATT HPS ON 30' STEEL POLES WITH UNDERGROUND WIRING \$ 16,697.10

COST OF OPERATION AND ROUTINE MAINTENANCE 16,697.10
 10% ADMINISTRATION FEE 1,669.71
 TOTAL ANNUAL COST TO THE DISTRICT = \$ 18,366.80

ASSESSMENT BASED ON 12 MONTHS -
 ANNUAL ASSESSMENT FOR AN AVERAGE
 87,166 SQ.FT. LOT IS \$316.67.

ANNUAL SQUARE FOOT COST = 0.003632949

PARCEL	BLOCK	LOT	SUB-DIVISION	NAME	PROPERTY ADDRESS	SET UP AREA (SQUARE FEET)	ANNUAL COST
1179400	3	13	North Park Addition	North Park Investments LLC		43,081	156.51
1179500	3	14	North Park Addition	North Park Investments LLC		51,096	185.63
1179600	3	15	North Park Addition	North Park Investments LLC		46,435	168.70
1179700	3	16 - 18	North Park Addition	Molerway Freight Lines		143,879	522.71
1180000	3	19 - 20	North Park Addition	T D Properties LLC	4901 N. Star Blvd	109,858	399.11
1180050	4	1	North Park Addition	Scherr Rick & Doreen	5101 N. Star Blvd	105,807	384.39
1180300	4	4	North Park Addition	Scherr Rick & Doreen		72,353	262.85
1180400	4	5	North Park Addition	Shanahan Steven F & Kirsty L	5006 N. Star Blvd	29,926	108.72
1180500	4	6	North Park Addition	Miller Douglas M & Kathryn A		30,013	109.04
1180600	4	7	North Park Addition	Madison W Larry		30,013	109.04
1180700	4	8	North Park Addition	Tonne Mark W	4808 N. Star Blvd	30,013	109.04
1180800	4	9	North Park Addition	Malisani Properties	4800 N. Star Blvd	38,420	139.58
1180900	4	10	North Park Addition	Malisani Properties	4708 N. Star Blvd	37,723	137.05
1181000	4	11	North Park Addition	Lindstrom Paul H & Sharon A		38,071	138.31
1181100	4	12	North Park Addition	Lindstrom Paul H & Sharon A		41,121	149.39
1181400	4	13 - 15	North Park Addition	Lindstrom Paul H & Sharon A	4500 N. Star Blvd	164,221	596.61
1181500	5	1	North Park Addition	Century Warehousing Inc.	4414 N. Star Blvd	89,516	325.21
1181600	5	2	North Park Addition	Harpine Royal W & Susan K	4404 N. Star Blvd	69,740	253.36
1181700	5	3	North Park Addition	Exchange Accomodators Inc.		80,020	290.71
1181800	5	4	North Park Addition	Exchange Accomodators Inc.		80,020	290.71
1181900	5	5	North Park Addition	Henry Charles S & Kaylee A	4212 N. Star Blvd	86,162	313.02
1182000	5	6	North Park Addition	Nimmick Bradley W & Margaret A		59,634	216.65
1182100	5	7	North Park Addition	Heisler Thomas	4120 N. Star Blvd	62,509	227.09
1182200	5	8	North Park Addition	Bergstrom Dustin	4106 N. Star Blvd	38,681	140.53
1182400	5	9 & 10	North Park Addition	Stacey Transfer & Storage	4000 N. Star Blvd	145,578	528.88
1182500	5	11 - 16	North Park Addition	Zadco		396,832	1,441.67
1182800	6	1	North Park Addition	Matz Properties LLC	1215 38th St N.	343,557	1,248.13

EXHIBIT B

SPECIAL LIGHTING DISTRICT - INDUSTRIAL "SLD-I" 1298

48 - 250 WATT HPS ON 30' STEEL POLES WITH UNDERGROUND WIRING	\$ 16,697.10
COST OF OPERATION AND ROUTINE MAINTENANCE	16,697.10
10% ADMINISTRATION FEE	<u>1,669.71</u>
TOTAL ANNUAL COST TO THE DISTRICT =	\$ <u>18,366.80</u>
ANNUAL SQUARE FOOT COST =	0.003632949

ASSESSMENT BASED ON 12 MONTHS -
ANNUAL ASSESSMENT FOR AN AVERAGE
87,166 SQ.FT. LOT IS \$316.67.

PARCEL	BLOCK	LOT	SUB-DIVISION	NAME	PROPERTY ADDRESS	SET UP AREA (SQUARE FEET)	ANNUAL COST
1182900	6	2 - 3	North Park Addition	Flawless Auto Body LLP	1111 38th St N.	112,167	407.50
1183100	6	4 - 6	North Park Addition	Great Falls Transit District	3905 N. Star Blvd	152,329	553.40
1183400	7	1	North Park Addition	Voegeles Inc.	4101 N. Star Blvd	167,750	609.43
1183500	7	2	North Park Addition	Voegeles Inc.	4119 N. Star Blvd	76,840	279.16
1183600	7	3	North Park Addition	Doors & Hardware Unlimited Inc.	4125 N. Star Blvd	64,164	233.10

TOTALS: 5,055,618 \$18,366.80