

RESOLUTION NO. 9363

A RESOLUTION OF INTENTION BY THE CITY COMMISSION OF THE CITY OF GREAT FALLS, MONTANA, TO EXTEND THE BOUNDARIES OF SAID CITY TO INCLUDE THE UNINCORPORATED PORTION OF THE AMENDED PLAT OF BLOCKS 1 AND 3, FIRST ADDITION TO GREAT FALLS CLINIC ADDITION, LOCATED IN THE NW1/4 OF SECTION 17, TOWNSHIP 20 NORTH, RANGE 4 EAST, P.M.M., CASCADE COUNTY, MONTANA, DIRECTING NOTICE TO BE GIVEN BY THE CITY CLERK AS PROVIDED BY LAW.

● * * * * *

WHEREAS, the City of Great Falls is a city incorporated under the laws of the State of Montana, and having a population of more than ten thousand (10,000) is a city of the first class; and,

WHEREAS, there is contiguous to said City, but without the boundaries thereof, certain tracts or parcels of land situated in the County of Cascade, State of Montana, and described as follows:

A tract of land located in the NW ¼, Section 17 Township 20 North, Range 4 East, PMM, Cascade County, Montana, said tract being Lot 1 Block 3 of the First Addition to Great Falls Clinic Addition and being more particularly described as follows:

Beginning at the center of said Section 17; thence North 89°13'00" West, along the midsection line, a distance of 460.00 feet to the True Point of Beginning; thence North 89°13'00" West along said midsection line, a distance of 861.60 feet; thence North 00°35'27" East, along the easterly boundary of the Yeoman-Tynes Addition, a distance of 429.27 feet; thence along a curve to the left, having a central angle of 89°42'00" and a radius of 20.00 feet, an arc distance of 31.31 feet; thence South 89°06'33" East a distance of 274.93 feet; thence along a curve to the left, having a central angle of 90°18'00" and a radius of 20.00 feet, an arc distance of 31.52 feet; thence North 00°35'27" East a distance of 352.12 feet; thence along a curve to the left having a central angle of 75°27'36" and a radius of 20.00 feet, an arc distance of 26.34 feet; thence along a curve to the left having a central angle of 14°11'37" and a radius of 280.00 feet, an arc distance of 69.36 feet; thence North 00°55'59" East, a distance of 18.00 feet; thence South 89°26'22" East, a distance of 491.87 feet; thence South 00°30'55" West, along the boundary of the B.G.M. tracts, a distance of 811.50 feet to the True Point of Beginning and containing 13.1037 acres.

all as shown on the map attached hereto marked Exhibit "A" and by this reference made a part hereof, and according to the Minor Plat of First Addition to Great Falls Clinic Addition and the Amended Plat of Blocks 1 and 3, First Addition to Great Falls Clinic Addition; and,

WHEREAS, Section 7-2-4601, Montana Code Annotated, provides that whenever the owners of real property contiguous to any incorporated city of the first class petition to have said property made a part of the municipal corporation, such lands may be embraced within the corporate limits thereof and the boundaries of such city of the first class extended so as to include the same.

NOW, THEREFORE, BE IT RESOLVED BY THE COMMISSION OF THE CITY OF GREAT FALLS, MONTANA;

That in its judgment it will be to the best interest of said City of Great Falls and the inhabitants thereof, that the boundaries of said City of Great Falls shall be extended so as to include: "THE UNINCORPORATED PORTION OF THE AMENDED PLAT OF BLOCKS 1 AND 3, FIRST ADDITION TO GREAT FALLS CLINIC ADDITION, LOCATED IN THE NW1/4 OF SECTION 17, TOWNSHIP 20 NORTH, RANGE 4 EAST, P.M.M., CASCADE COUNTY, MONTANA."

BE IT FURTHER RESOLVED BY SAID CITY COMMISSION: That Tuesday, the 2nd day of March, 2004, at 7:00 P.M., in the Commission Chambers at the Great Falls Civic Center, Great Falls, Montana, be and the same is hereby set as the time and place for a public hearing at which time the Great Falls City Commission shall hear all persons and all things relative to the proposed annexation of "THE UNINCORPORATED PORTION OF THE AMENDED PLAT OF BLOCKS 1 AND 3, FIRST ADDITION TO GREAT FALLS CLINIC ADDITION, LOCATED IN THE NW1/4 OF SECTION 17, TOWNSHIP 20 NORTH, RANGE 4 EAST, P.M.M., CASCADE COUNTY, MONTANA."

BE IT FURTHER RESOLVED BY SAID CITY COMMISSION that the City Clerk of said City shall, at the aforesaid public hearing before the said City Commission and after expiration of a twenty (20) day period following the first publication of notice of passage of this Resolution, lay before the City Commission all communications in writing by her so received pertaining to said annexation.

PASSED AND ADOPTED by the City Commission of the City of Great Falls, Montana, on this 3rd day of February, 2004.

Randall H. Gray, Mayor

ATTEST:

Carolyn M. Broquist, Deputy City Clerk

(SEAL OF CITY)

Approved for legal content: City Attorney

State of Montana)
County of Cascade :ss
City of Great Falls)

I, Carolyn M. Broquist, Deputy City Clerk of the City of Great Falls, Montana, do hereby certify that the foregoing Resolution No. 9363 was placed on its final passage by the Commission of the City of Great Falls, Montana, at a meeting thereof held on the 3rd day of February, 2004, and approved by the Mayor of said City on the 3rd day of February, 2004.

IN WITNESS WHEREOF, I have hereunto set my hand and affixed the Seal of said City this 3rd day of February, 2004.

Carolyn M. Broquist, Deputy City Clerk

(SEAL OF CITY)

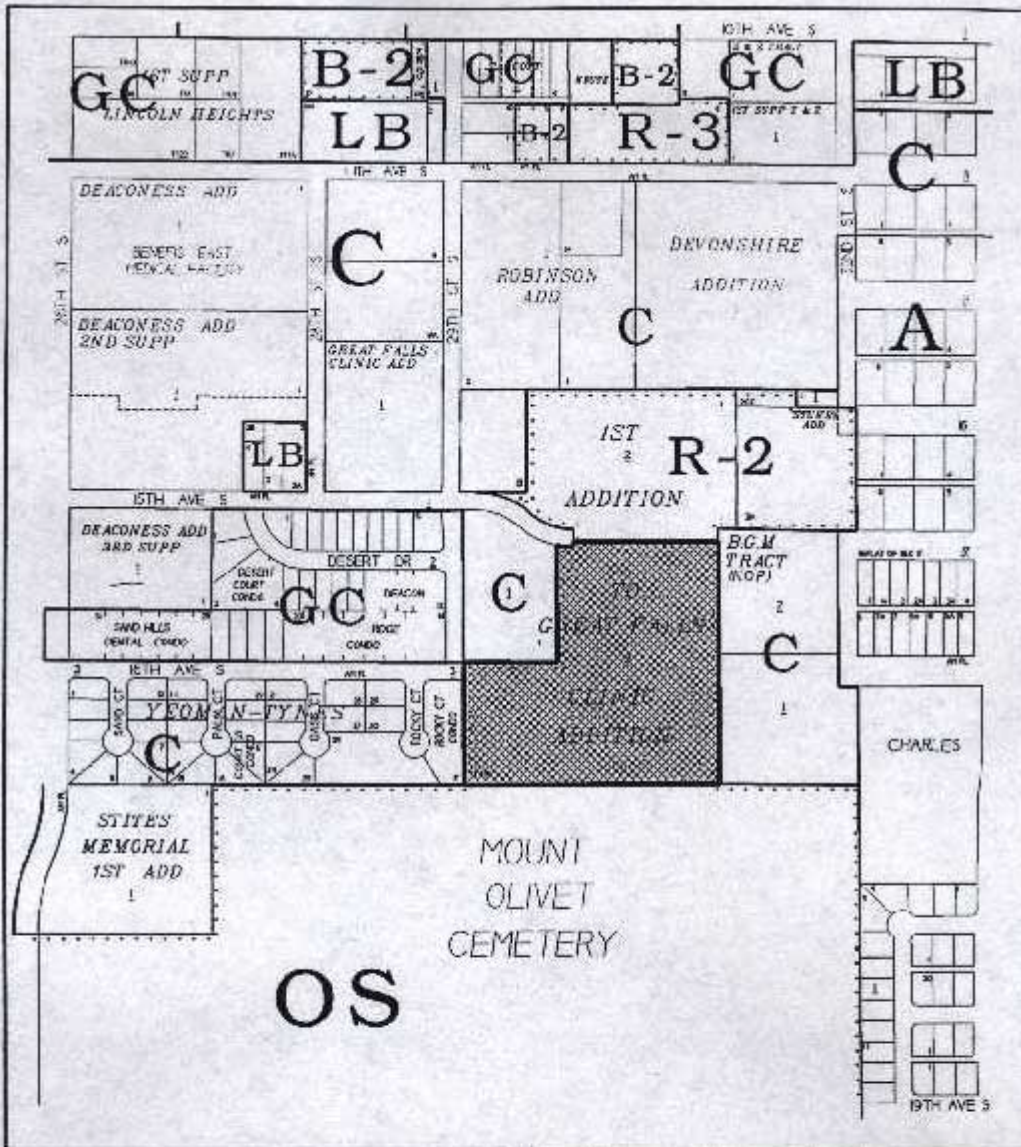

"VICINITY MAP"



AREA PROPOSED TO BE ANNEXED AND ZONED C RESIDENTIAL WITH A CONDITIONAL USE FOR A MEDICAL FACILITY

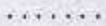

EXISTING CITY LIMITS



ZONING DISTRICT BOUNDARY



1/4/2003

CITY ZONING

A- SINGLE FAMILY

C- MULTI-FAMILY

LB- LOCAL BUSINESS

GC- GENERAL COMMERCIAL

COUNTY ZONING

R-2- LOW DENSITY RESIDENTIAL

R-3- MEDIUM DENSITY RESIDENTIAL

B-2- GENERAL BUSINESS

OS- OPEN SPACE

EXHIBIT "A"