

RESOLUTION NO. 9316

A RESOLUTION BY THE CITY COMMISSION OF THE CITY OF GREAT FALLS, MONTANA, TO EXTEND THE BOUNDARIES OF SAID CITY TO INCLUDE WHISPERING RIDGE ADDITION, PHASE 3, LOCATED IN THE SE1/4 OF SECTION 17, TOWNSHIP 20 NORTH, RANGE 4 EAST, P.M.M., CASCADE COUNTY, MONTANA, MORE PARTICULARLY DESCRIBED HEREINBELOW; ALL AS SHOWN ON THE MAP ATTACHED HERETO MARKED EXHIBIT "A" AND BY THIS REFERENCE MADE A PART HEREOF.

● \* \* \* \* \*

WHEREAS, the City of Great Falls is a city incorporated under the laws of the State of Montana, and having a population of more than ten thousand (10,000) is a city of the first class; and,

WHEREAS, there is contiguous to said City, but without the boundaries thereof, certain tracts or parcels of land situated in the County of Cascade, State of Montana, and described as follows:

Whispering Ridge Addition, Phase 3, located in the SE1/4 of Section 17, Township 20 North, Range 4 East, P.M.M., Cascade County, Montana, and containing 6.46 acres,

all as shown on the map attached hereto marked Exhibit "A" and by this reference made a part hereof, and according to the final plat of Whispering Ridge Addition, Phase 3; and,

WHEREAS, Section 7-2-4601, Montana Code Annotated, provides that whenever the owners of real property contiguous to any incorporated city of the first class petition to have said property made a part of the municipal corporation, such lands may be embraced within the corporate limits thereof and the boundaries of such city of the first class extended so as to include the same.

WHEREAS, in the judgement of the City Commission of said City, expressed by Resolution No. 9303 entitled:

A RESOLUTION OF INTENTION BY THE CITY COMMISSION OF THE CITY OF GREAT FALLS, MONTANA, TO EXTEND THE BOUNDARIES OF SAID CITY TO INCLUDE WHISPERING RIDGE ADDITION, PHASE 3, LOCATED IN THE SE ¼ OF SECTION 17, TOWNSHIP 20 NORTH, RANGE 4 EAST, P.M.M., CASCADE COUNTY, MONTANA, DIRECTING NOTICE TO BE GIVEN BY THE CITY CLERK AS PROVIDED BY LAW.

duly and regularly passed and adopted on the 15<sup>th</sup> day of April, 2003, stating that it will be in the best interest of said city and the inhabitants thereof, that the boundaries of said City of Great Falls shall be extended so as to include “WHISPERING RIDGE ADDITION, PHASE 3, LOCATED IN THE SE1/4 OF SECTION 17, TOWNSHIP 20 NORTH, RANGE 4 EAST, P.M.M., CASCADE COUNTY, MONTANA.”

WHEREAS, the City Clerk of said City, pursuant to said Resolution and the statute in such case made and provided, forthwith caused to be published in the Great Falls Tribune, the newspaper published nearest said tract of land, at least once a week for two (2) successive weeks, a notice to the effect that said Resolution had been duly and regularly passed, and that for a period of twenty (20) days after the first publication of said notice, said City Clerk would receive expressions of approval or disapproval, in writing, of the said proposed extension of the boundaries of said City, and also stating therein the time and place set for the public hearing provided by said Resolution; and,

WHEREAS, the first publication of said notice hereinbefore referred to was the 27th day of April, 2003; and,

WHEREAS, the City Clerk has received no expressions of approval or disapproval of the proposed alterations of the boundaries of the municipality, within the time allowed by said notice; and,

WHEREAS, a public hearing was held by the City Commission of the City of Great Falls on May 20, 2003, at 7:00 P.M., in the Commission Chambers of the Great Falls Civic Center, where said Commission heard all persons and all things relative to the proposed annexation of said property;

NOW, THEREFORE, the City Commission now finds that it is to the best interest of the City of Great Falls and its inhabitants to proceed with the incorporation of said territory into the City of Great Falls; and,

WHEREAS, all of the proceedings herein have been conducted in strict compliance with and in conformity to the law and constitution of the State of Montana, and all conditions, acts, and things required to be done precedent to and in the passage and adoption of this resolution have been properly and legally done, and performed;

NOW, THEREFORE, BE IT RESOLVED BY THE COMMISSION OF THE CITY OF GREAT FALLS, MONTANA;

That the boundaries of the City of Great Falls, Montana, be and the same are hereby extended so as to embrace and include within the corporate limits of said city all of the land hereinabove described, included as: “WHISPERING RIDGE ADDITION, PHASE 3, LOCATED IN THE SE1/4 OF SECTION 17, TOWNSHIP 20 NORTH, RANGE 4 EAST, P.M.M., CASCADE COUNTY, MONTANA.”

BE IT FURTHER RESOLVED BY THE COMMISSION OF THE CITY OF GREAT FALLS, MONTANA:

The Cascade County Clerk and Recorder is hereby authorized and directed to change the appropriate district boundaries of the City of Great Falls, Montana, to include said tract of land; and,

BE IT FURTHER RESOLVED BY SAID CITY COMMISSION that this Resolution shall become effective thirty (30) days after its passage and approval.

PASSED AND ADOPTED by the City Commission of the City of Great Falls, Montana, on this 20th day of May, 2003.

\_\_\_\_\_  
Randall H. Gray, Mayor

ATTEST:

\_\_\_\_\_  
Melodi A. Wald, Deputy City Clerk

(SEAL OF CITY)

\_\_\_\_\_  
Approved for legal content: City Attorney

State of Montana        )  
County of Cascade     :ss  
City of Great Falls    )

I, Melodi A. Wald, Deputy City Clerk of the City of Great Falls, Montana, do hereby certify that the foregoing Resolution No. 9316 was placed on its final passage by the Commission of the City of Great Falls, Montana, at a meeting thereof held on the 20th day of May, 2003, and approved by the Mayor of said City on the 20th day of May, 2003.

IN WITNESS WHEREOF, I have hereunto set my hand and affixed the Seal of said City this 20th day of May, 2003.

\_\_\_\_\_  
Melodi A. Wald, Deputy City Clerk

(SEAL OF CITY)

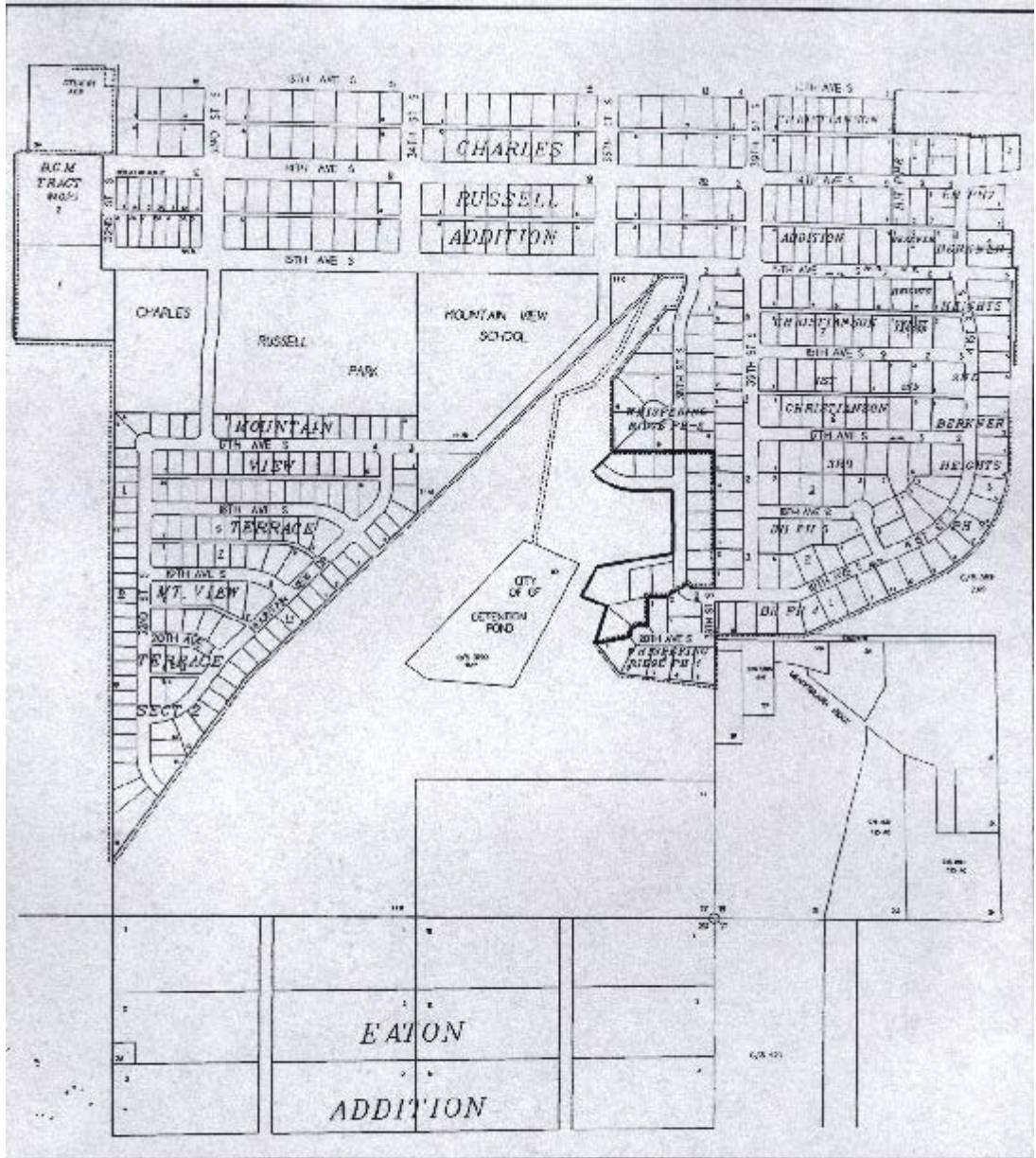

FINAL PLAT OF WHISPERING RIDGE  
ADDITION, PHASE 3



EXISTING CITY LIMITS



3/27/2013